

Construction (Design and Management) Regulations
 Design risk assessments are carried out throughout the design stage of this project in accordance with company procedures and manuals. Where reasonably possible all areas of risk applicable to design and end use of the construction have been identified and then eliminated, mitigated or recorded as a residual risk. Note the general risk of which a competent designer or contractor should be aware are not included. This drawing is to be read in conjunction with the Pre-construction Information and all related documents prepared in accordance with the current Construction (Design and Management) Regulations 2015 and all applicable Health and Safety legislation as currently enacted.

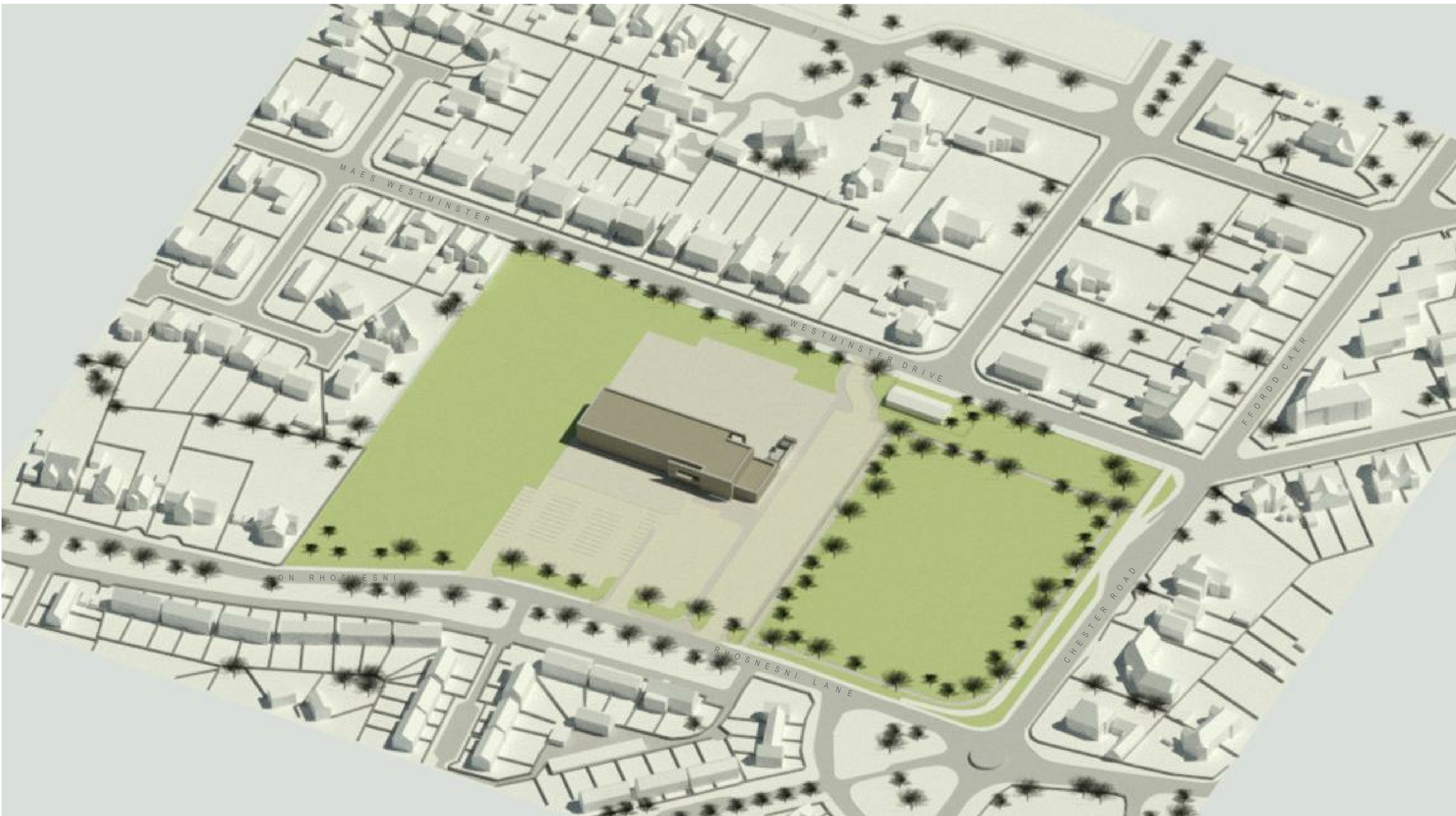

Golygfa tua Gogledd-Oriolewin
 View to North West



Golygfa tua De-Oriolewin
 View to South West

P03	Updated to Bilingual Labelling	J.W J.W K.O.H	27/01/2020
P02	Amendments to plan	J.W J.W K.O.H	09/01/2020
P01	Initial issue	J.W J.W K.O.H	17/12/2019
REV.	DESCRIPTION (DRAWN BY)	CHECKED BY APPROVED BY	DATE
RBA	PLAN OF WORK 2013 WORKSTAGE	LEVEL OF MODEL DEFINITION (LoD)	
Stage 1	Preparation and Brief	LoD 2 - Conceptual Model	
PURPOSE OF ISSUE - SUITABLE FOR...	BS1192 STATUS		
Pol 1 - Information	Status A - Approved		

lawray architects
 penseiri

CARDIFF 029 2052 8140
 LONDON 0207 138 3560
 WREXHAM 01978 357 887
 www.lawray.co.uk

CLIENT
 CYNGOR BWRDEISTREF SIROL WRECSAM -
 WREXHAM COUNTY BOROUGH COUNCIL

PROJECT TITLE
 CAIS AM YSGOL GYNRADD, FFORDD CAER,
 WRECSAM - PROPOSED PRIMARY SCHOOL,
 CHESTER ROAD, WREXHAM

DRAWING TITLE
 GOLYGFYDD 3D DDANGOSOL - INDICATIVE 3D
 SITE VIEWS

PROJECT No 19226 SCALE @ A1

DRAWING No	PROJECT - ORIGINATOR - VOLUME - LEVEL - TYPE - ROLE - NUMBER	REVISION
05/19/2020	NAS-LAW-X-G00-DR- A-093001	P03

DO NOT SCALE Any discrepancy or query concerning this drawing should be referred to the Architect
 Copyright © LAWRAY LIMITED
 Registered Office: Greenmeadow Springs, 1 Cae Gwynedd, Tongwynlais, CARDIFF CF15 7AB
 Reg. Co. No. 2724178. VAT Reg. No. 134 2148 06